



AGM LEAD ACID BATTERY

20-12 Cyclic M5-F



MAIN INFORMATION / INFORMATIONS GÉNÉRALES

| | |
|---|---------------------------|
| BRAND / MARQUE | NX |
| TECHNOLOGY / TECHNOLOGIE | AGM Lead acid |
| NOMINAL VOLTAGE / TENSION NOMINALE | 12V |
| NOMINAL CAPACITY / CAPACITÉ NOMINALE | 20Ah (20hr) |
| DIMENSIONS / DIMENSIONS | |
| • Length / Longueur | 181.5 ± 2mm (7.14 inches) |
| • Width / Largeur | 77 ± 1mm (3.03 inches) |
| • Height / Hauteur | 167.5 ± 2mm (6.59 inches) |
| • Total height with terminals / Hauteur totale (avec cosSES) | 167.5 ± 2mm (6.59 inches) |
| WEIGHT (± 4 %) / POIDS (± 4 %) | Approx 6kg (13.23lbs) |
| TERMINAL / TYPE DE COSSES | M5-F |
| CASING / TYPE DE BAC | UL94 HB (Standard ABS) |
| COLOR / COULEUR DE BAC | Black top and black case |



TECHNICAL INFORMATION / INFORMATIONS TECHNIQUES

| | |
|--|--|
| CAPACITY / CAPACITÉ | 20.7Ah / 0.207A (20hr, 1.80V/cell, 25°C/77°F) 18.9 Ah / 0.945A (10hr, 1.80V/cell, 25°C/77°F) 18.0 Ah / 1.80A (5hr, 1.75V/cell, 25°C/77°F) 16.0Ah / 3.20A (3hr, 1.75V/cell, 25°C/77°F) 11.0 Ah / 11.0A (1hr, 1.60V/cell, 25°C/77°F) |
| DISCHARGE CURRENT / COURANT DE DÉCHARGE | 270A (5S) |
| INTERNAL RESISTANCE / RÉSISTANCE INTERNE | Approx 15mΩ |
| OPERATING TEMPERATURE RANGE / PLAGES DE TEMPÉRATURE | |
| • Discharging / Décharge | -15°~50°C (5 ~122°F) |
| • Charging / Charge | 0°~40°C (32 ~104°F) |
| • Storage / Stockage | -15°~40°C (5 ~104°F) |
| NOMINAL OPERATING TEMPERATURE / TEMPÉRATURE D'UTILISATION | 25 ± 3°C (77 ± 5°F) |
| CAPACITY VS TEMPERATURE / CAPACITÉ SELON LA TEMPÉRATURE | 40°C (104°F) 103% 25°C (77°F) 100% 0°C (32°F) 86% |

Terminal

Unité : mm / Unit: inches

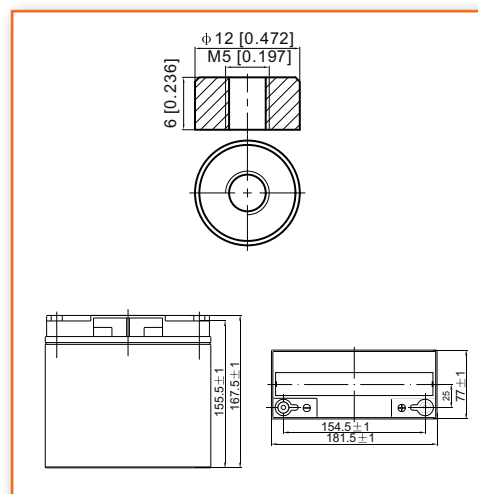

APPLICATIONS

Telecommunications / Télécoms
Green energy system / Systèmes d'énergies renouvelables
Solar stations / Solaire
Emergency light / Eclairage de secours
Trafficlights / Feux électriques
Aircraft signal / Signal d'avion

Railway signal / Signalisation ferroviaire
Street Signs / Signalisation routière
Alarm and security system / Alarme et sécurité
Caravans / Caravanes
Camping cars / Camping cars
Boats / Bateaux

| | |
|--|---------------------------------------|
| TMD 1 Description, classe : UN 2800 – accumulateurs inversables remplis d'électrolyte liquide, 8, none, (E) | |
| ADR : Not regulated | IMDG Not regulated |
| IATA : Exempt | Procédure TMD PROC 2 : UN 2800 |



CONSTANT CURRENT DISCHARGE (AMPERES) AT 25°C
TABLE DE DÉCHARGE À COURANT ET PUISSANCE CONSTANTS (A) À 25°C

| F.V/Temps | 15min | 20min | 30min | 45min | 1h | 2h | 3h | 4h | 5h | 8h | 10h | 20h | 48h | 100h |
|------------|-------|-------|-------|-------|------|------|------|------|------|------|------|-------|-------|-------|
| 1.85V/cell | 20.6 | 17.1 | 13.3 | 10.5 | 8.52 | 5.58 | 4.19 | 3.43 | 2.90 | 2.03 | 1.72 | 0.916 | 0.412 | 0.203 |
| 1.80V/cell | 22.8 | 18.8 | 14.3 | 11.2 | 8.98 | 5.94 | 4.42 | 3.60 | 3.05 | 2.13 | 1.80 | 0.945 | 0.419 | 0.207 |
| 1.75V/cell | 25.3 | 20.6 | 15.4 | 12.0 | 9.69 | 6.22 | 4.68 | 3.76 | 3.20 | 2.19 | 1.84 | 0.965 | 0.426 | 0.209 |
| 1.70V/cell | 27.7 | 22.5 | 16.9 | 12.5 | 10.2 | 6.56 | 4.89 | 3.91 | 3.33 | 2.27 | 1.90 | 0.984 | 0.431 | 0.212 |
| 1.65V/cell | 29.3 | 23.8 | 17.9 | 13.3 | 10.6 | 6.79 | 5.07 | 4.05 | 3.40 | 2.33 | 1.94 | 1.007 | 0.438 | 0.215 |
| 1.60V/cell | 32.1 | 25.8 | 19.0 | 13.7 | 11.0 | 7.07 | 5.24 | 4.18 | 3.52 | 2.39 | 1.98 | 1.031 | 0.446 | 0.217 |

CONSTANT POWER DISCHARGE (WATTS) AT 25°C
DÉCHARGE À PUISSANCE CONSTANTE (WATTS) À 25°C

| F.V/Temps | 15min | 20min | 30min | 45min | 1h | 2h | 3h | 4h | 5h | 8h | 10h | 20h | 48h | 100h |
|------------|-------|-------|-------|-------|------|------|------|------|-------|------|------|------|-------|-------|
| 1.85V/cell | 38.8 | 32.6 | 25.6 | 20.4 | 16.7 | 11.0 | 8.24 | 6.77 | 5.74 | 4.04 | 3.45 | 1.83 | 0.829 | 0.407 |
| 1.80V/cell | 42.5 | 35.3 | 27.2 | 21.4 | 17.4 | 11.6 | 8.65 | 7.06 | 6.00 | 4.23 | 3.59 | 1.89 | 0.839 | 0.416 |
| 1.75V/cell | 46.5 | 38.3 | 29.0 | 22.8 | 18.7 | 12.1 | 9.12 | 7.35 | 6.29 | 4.34 | 3.67 | 1.93 | 0.851 | 0.418 |
| 1.70V/cell | 50.1 | 41.5 | 31.7 | 23.7 | 19.7 | 12.7 | 9.52 | 7.65 | 6.53 | 4.50 | 3.78 | 1.96 | 0.860 | 0.423 |
| 1.65V/cell | 52.9 | 43.7 | 33.3 | 25.1 | 20.3 | 13.1 | 9.85 | 7.90 | 6.66 | 4.61 | 3.86 | 2.01 | 0.875 | 0.429 |
| 1.60V/cell | 56.8 | 46.7 | 35.0 | 25.7 | 20.9 | 13.5 | 10.1 | 18.1 | 16.86 | 4.72 | 3.94 | 2.05 | 0.889 | 0.432 |

DISCHARGE CHARACTERISTICS
CARACTÉRISTIQUES DE DÉCHARGE

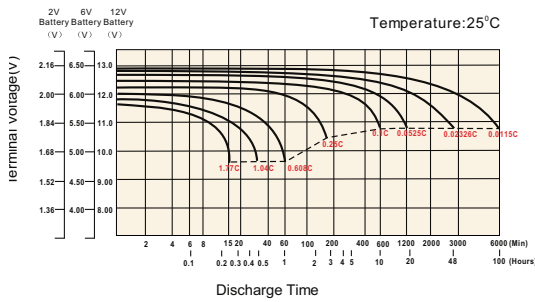

CYCLIC CHARGING CHARACTERISTICS
CARACTÉRISTIQUES DE CYCLAGE

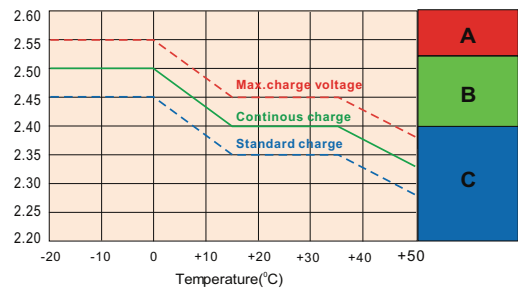

TEMPERATURE EFFECTS IN RELATION TO BATTERY CAPACITY
EFFET DE LA TEMPÉRATURE SUR LA BATTERIE

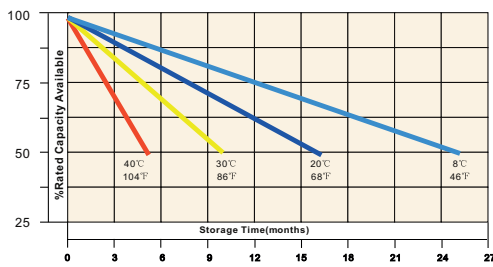

EFFECT OF TEMPERATURE ON LONG TERM FLOAT LIFE
EFFET DE LA TEMPÉRATURE SUR LA DURÉE DE VIE EN FLOATING

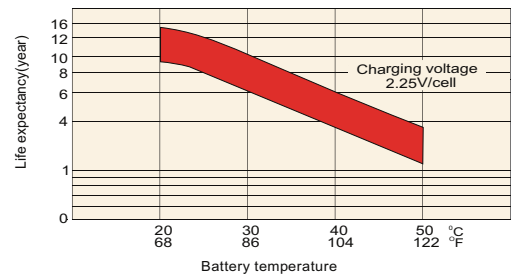

CYCLE LIFE IN RELATION TO DEPTH OF DISCHARGE
CYCLE DE VIE EN FONCTION DE LA PROFONDEUR DE LA DÉCHARGE

